

LOCKCELL®



AUTOMATIC STORAGE SYSTEMS



tmt®
Türkiye Metal Teknolojisi



ITOSB 12. STREET NO: 3/13/18
TUZLAPLUS 34953
TUZLA-ISTANBUL/TURKEY



info@tmtmakine.com.tr
www.tmtmakine.com.tr



+90 216 593 4361

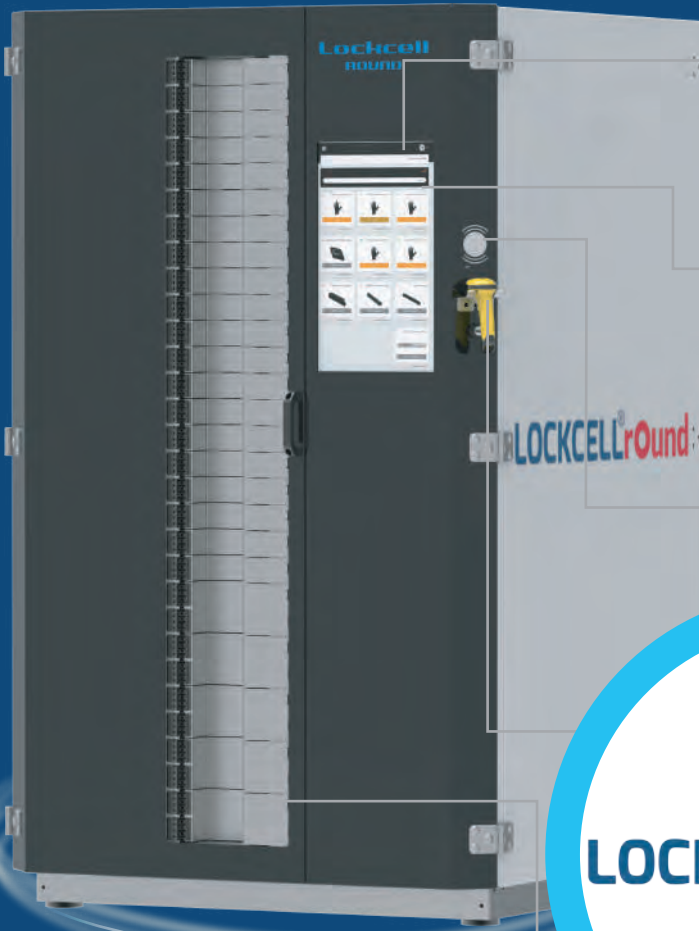

LOCKCELL®rOund

Your products are under control

LOCKCELL ROUND

Lockcell rOund offers maximum lock cell option on the purpose of storage small parts. Lockcell rOund is a new generation system in automated storage systems. LOCKCELL ROUND can reach maximum of 2340 locationnn. The machine is only one in its class through this location range and size. Therefore not only can storage many product range but also can storage PPE products which use much in safely. You can storage your products one by one due to high range number of cell and you definitely %100 bring under control through this.

It offers storage to different size products in %100efficiency due to different cell sizes.

Requested products come to front of cap with rotary tambour system and relevant cap will open automatically with up to down rowed cap system. You can reach products that you want on shortest route due to it.

Cutting tools, medicine, electronic equipment, industriel equipment, computer equipment, PPE, portable hand tools, keys can be storage with LOCKCELL ROUND.

LOCKCELL ROUND GENERAL FEATURES

- Rapid reaching due to perfect ergonomic design
- Possibility to store only one product in each cell
- Access to products in the other cells is impossible due to opening of the relevant cell.
- The first and only compact machine with 2340 locations in the world
- It offers ease of handling in Office or factory due to compact design with 1.2m x 1.2m size
- It offers possibility to storage many product range due to differents types of size and cell types.
- Cost savings due to optimization of current warehouse capacity.
- Greater productivity due to faster product access.
- Protection and safety of personnel and stored products.
- Barcode reader.
- High stock capability with large volume.
- Safe sheet metal structure.
- Oven-daying sheet metal parts.
- User login with password and/or card.
- Operating voltage: 230V/50Hz
- 21" touchscreen
- Windows10 Pro operating system
- Lockcell talas software.
- * Power supply (UPS)



WIDE USAGE AREA FOR EACH COMPANY

DIFFERENT WAREHOUSE SPACE FOR EACH PRODUCT

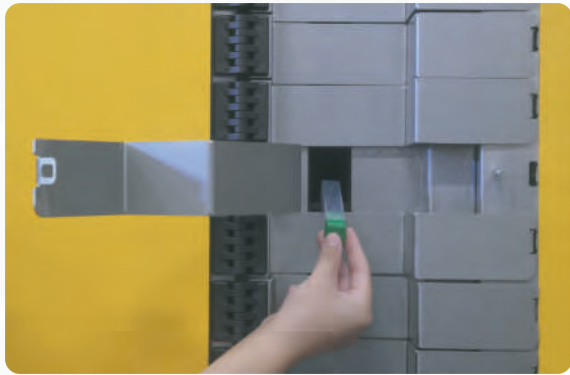

Fast product purchase

- It reaches the products selected with the product code, name or barcode in the fastest way.
- Only selected products are accessible.
- One or more products can be placed in the same eye.



Barcode reader

- Barcode reader to avoid coding errors.
- Fast product entry and exit.

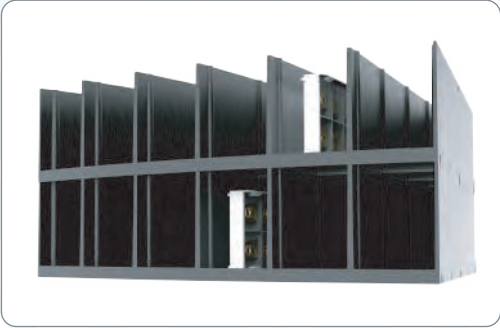

Cell type A

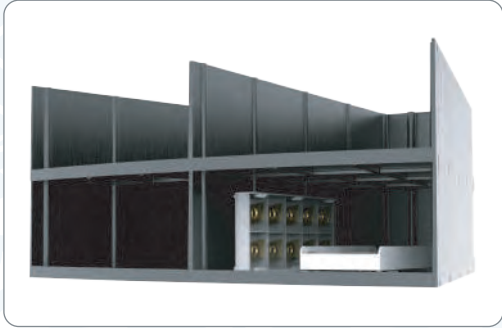

Cell type B

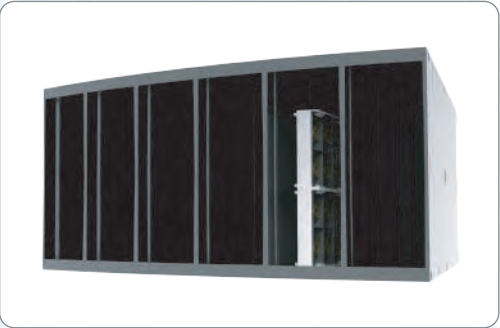

Cell type C

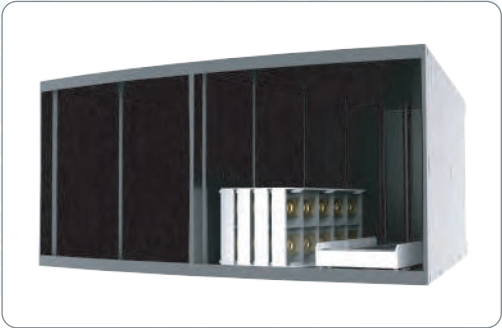

Cell type D

CELL TYPE		WIDTH W1/W2	HEIGHT	DEPTH
A		38 / 16	50	245
B		115 / 55	50	245
C		38 / 16	100	245
D		115/ 55	100	245
SAMPLE CELL CONFIGURATION				
TIP	NUMBER OF COVERS	EYE TYPE	NUMBER OF CELL IN ONE FLOOR	TOTAL NUMBER OF CELL
1	30	30*A	78	2340
2	30	30*B	26	780
3	15	15*C	78	1170
4	15	15*D	26	390
5	25	25*A	78	2080
	5	5*B	26	
6	20	20*A	78	1690
	5	5*D	26	
7	15	15*A	78	1560
	15	15*B	26	
8	10	10*A	78	1040
	10	10*D	26	
9	5	5*A	78	780
	5	5*B	26	
	10	10*D	26	
10	10	10*C	78	910
	5	5*D	26	

LOCKCELL®

TMT TOOLS

TMT TOOLS is the Turkish company which desingn and manufacture automated storage systems for every sector and industrial area with LOCKCELL brand. At the same time TMT TOOLS is manufacturing otomation aidet automated storage systems in order to storage for different size products, small electronic parts, medicine sector, big parts such as mould sector, otomobile and motor parts. Our basic principle is to accept customer satisfaction as our first priority, to provide solutions that add value to our customers, to provide a happy and reliable working environment by ensuring the continuous development of our employes and to produce value-added technological machines

LOCKCELL®*talas*
Industry 4.0 APPLICATIONS

LOCKCELL®*master*

LOCKCELL®*plus+*

LOCKCELL®*rOund*

LOCKCELL®*me d*

LOCKCELL®*cube*

LOCKCELL®*///ASRS*

LOCKCELL®*TOWER*

LOCKCELL®*X*



ITOSB 12. STREET NO: 3/13/18
TUZLAPLUS 34953
TUZLA-ISTANBUL/TURKEY



info@tmtmakine.com.tr
www.tmtmakine.com.tr



+90 216 593 4361